

040397

06-APR-2015 16:40 C:\chatham\2015 Chatham seal Spring overview map.dgn

### MAP #1

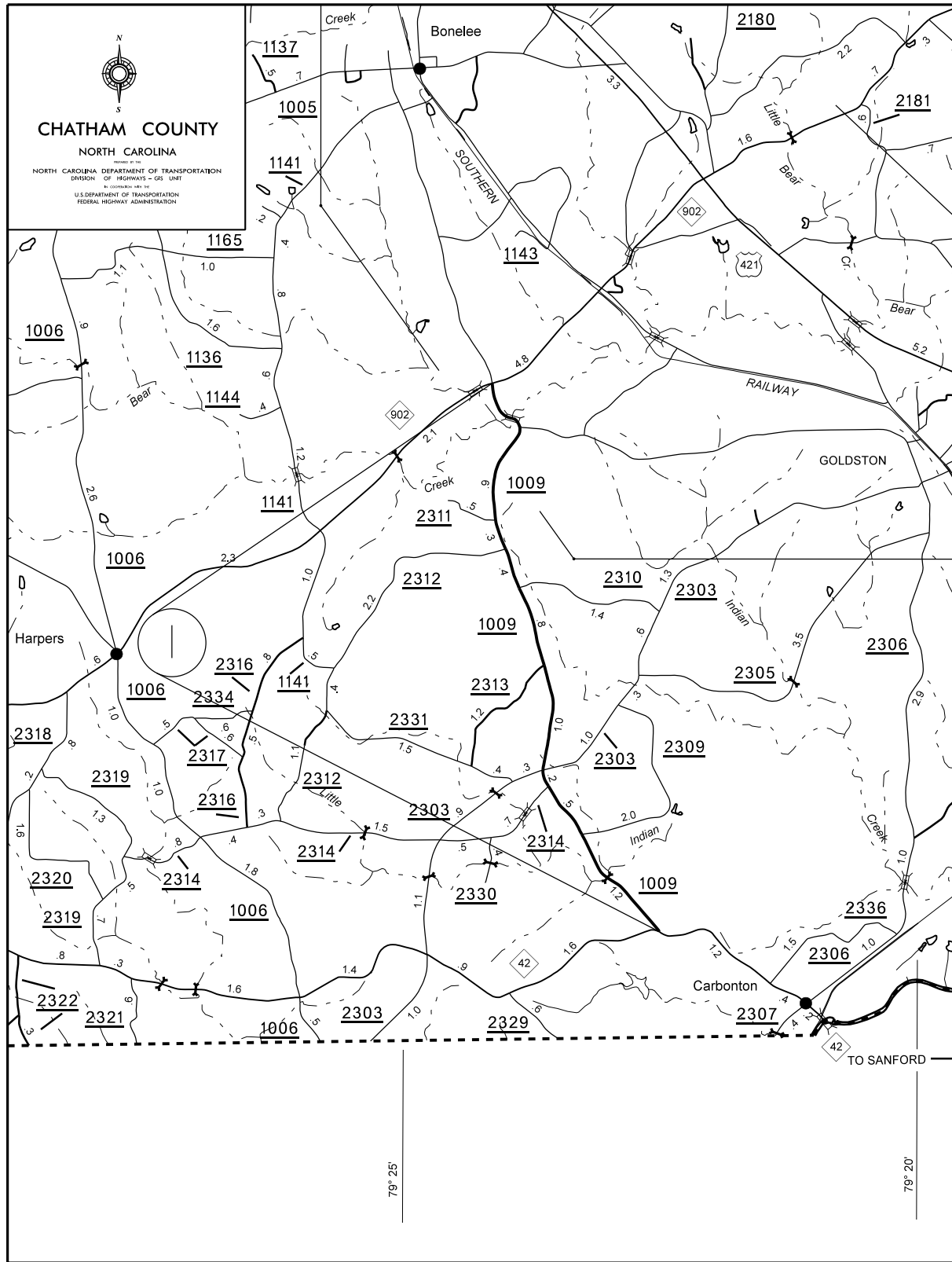

### MAPS #2 - #4, #8 & #9

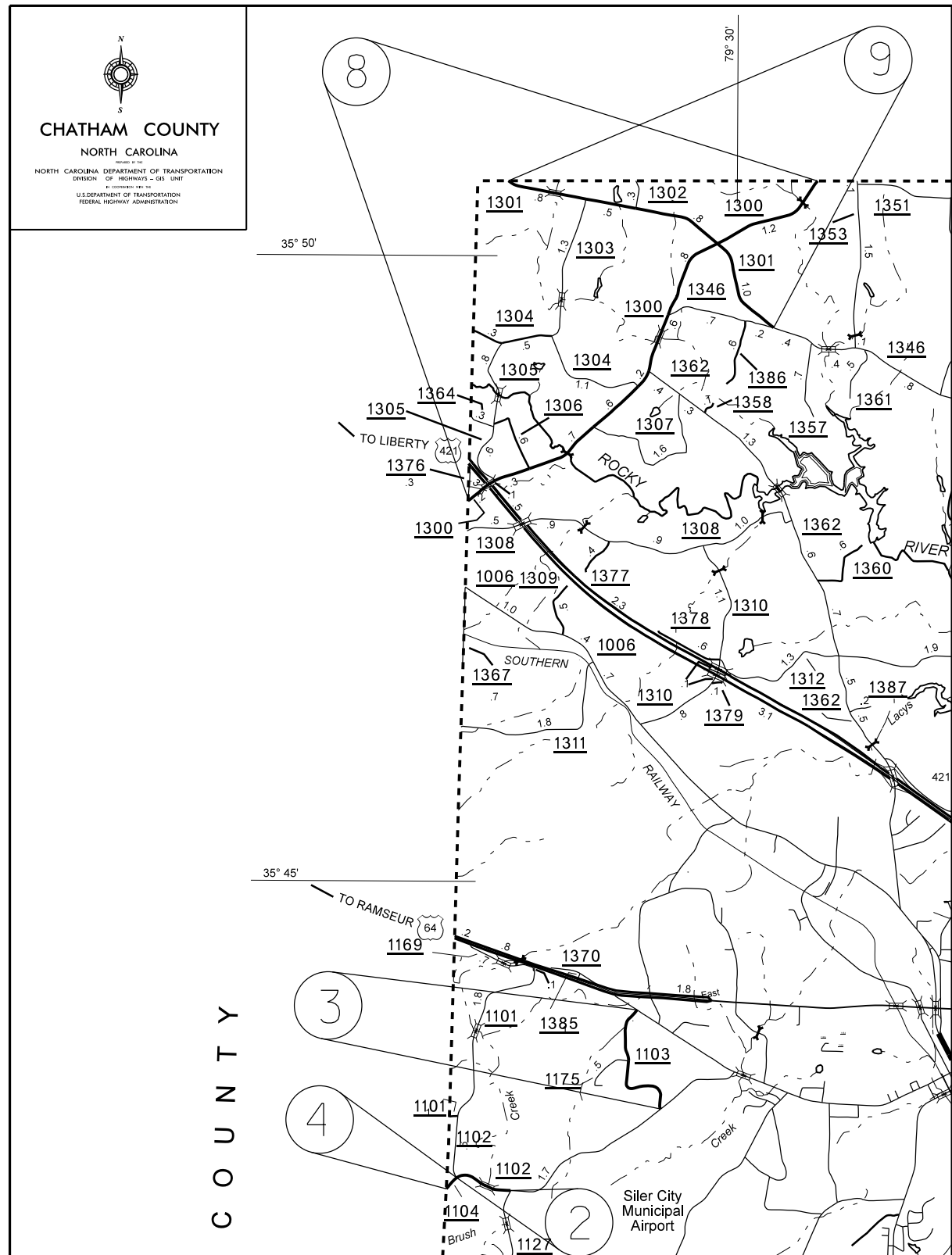

# MAPS #5 & #7

# MAPS #6, #10, #12, #18, #21 & #22

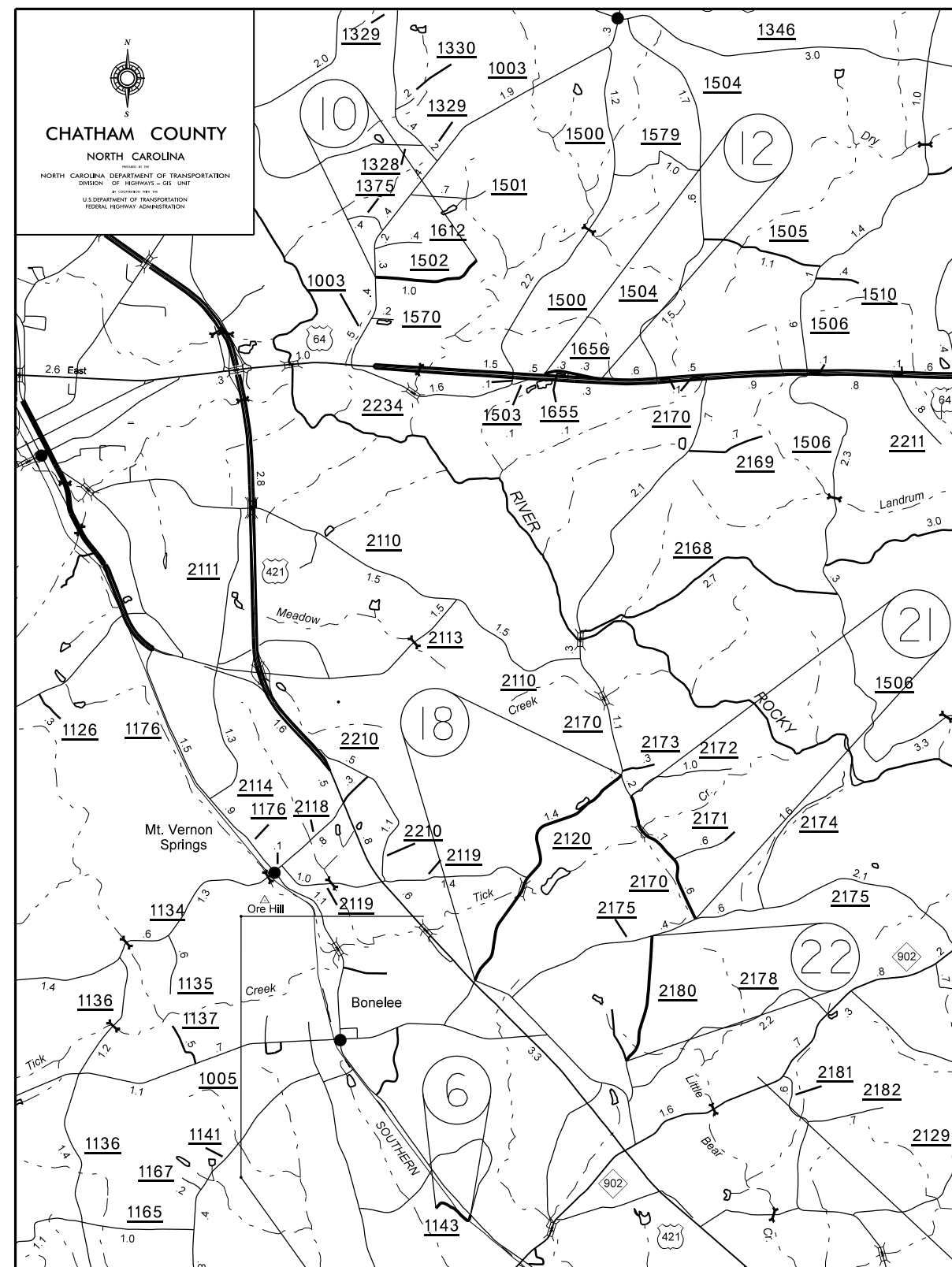
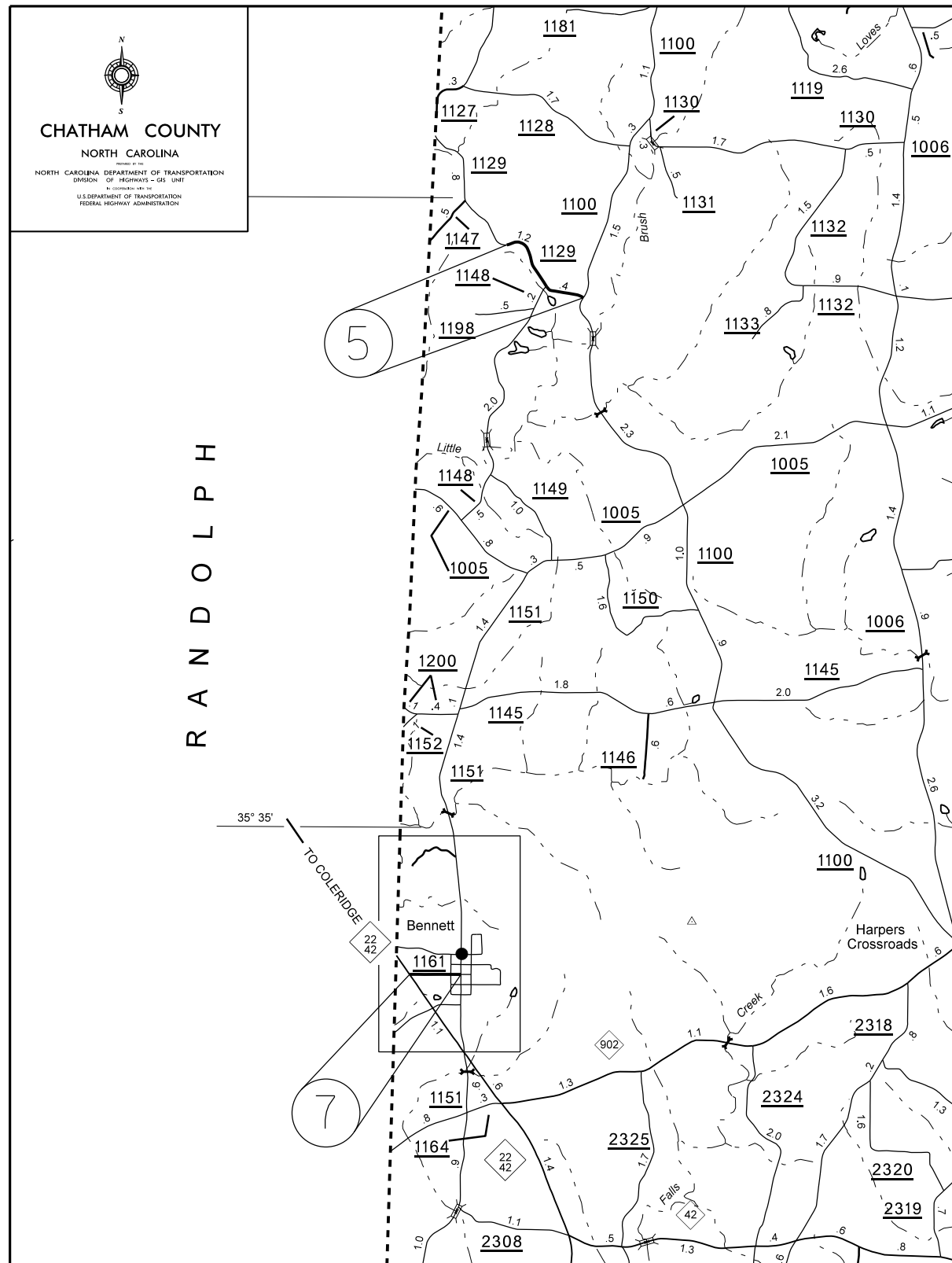

040397

06-APR-2015 16:10 C:\chatham\2015 Chatham seal Spring vicinity map.dgn

### MAPS #11, #13, #15 & #16

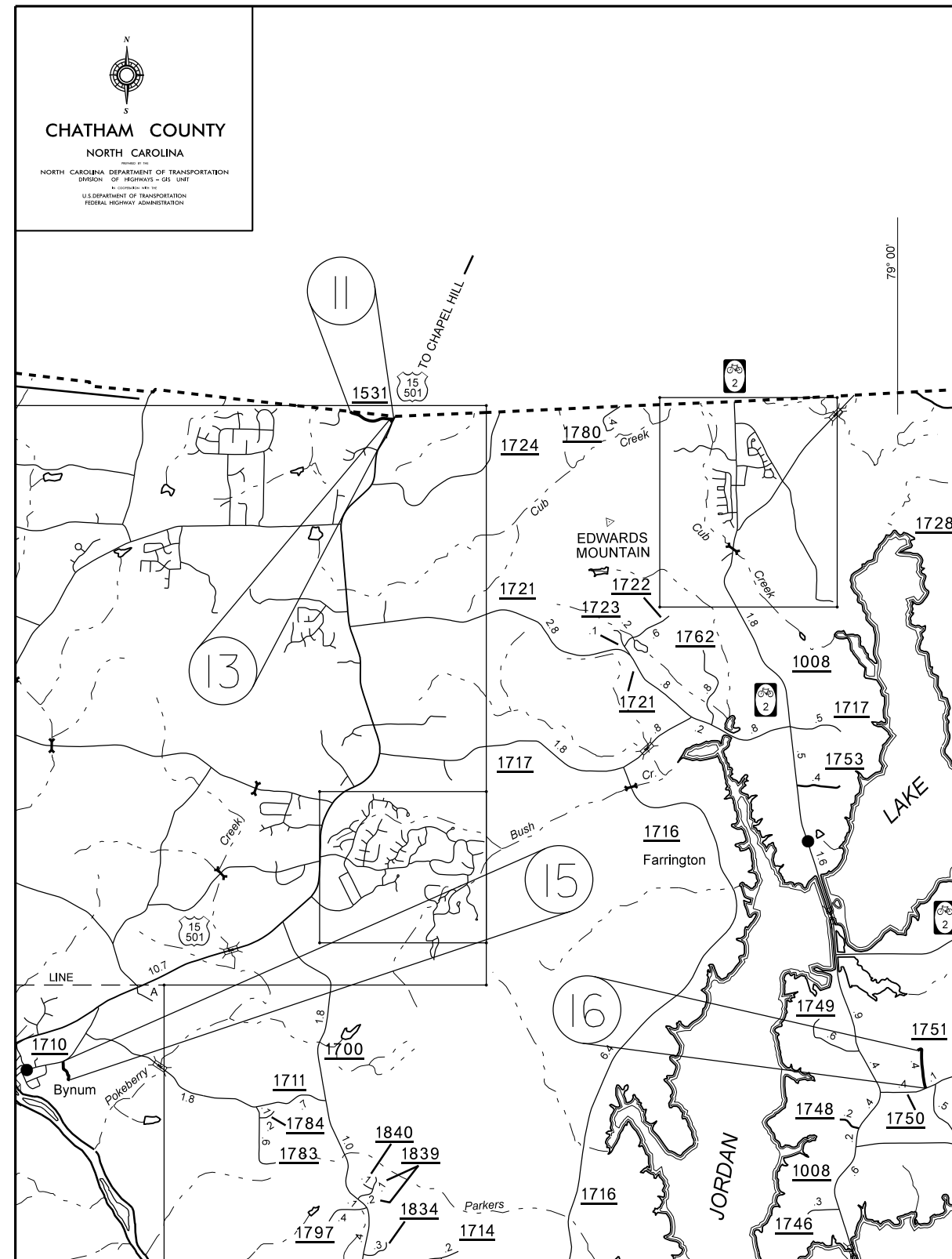

### MAPS #14, #17 & #23

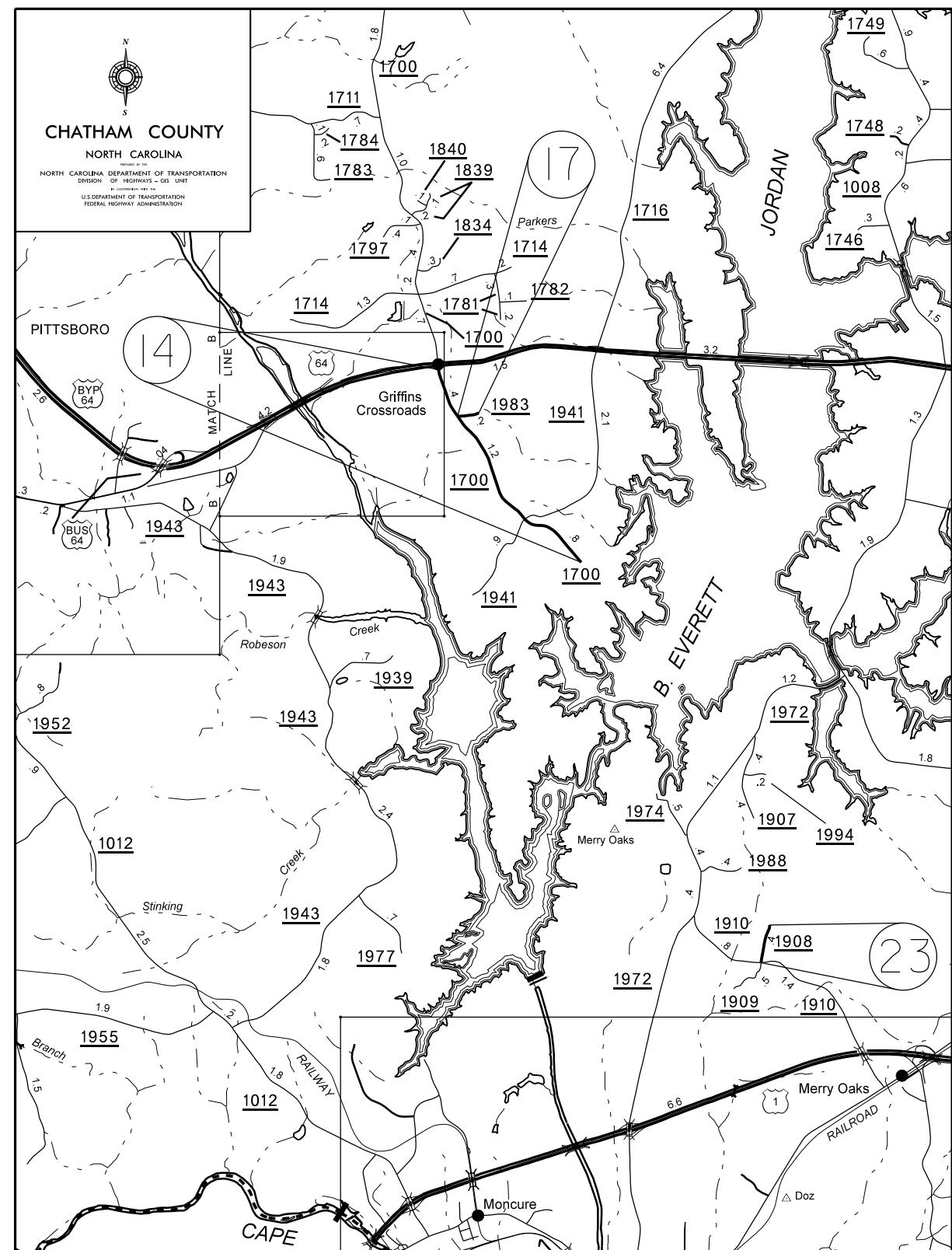

# MAPS #19 & #20

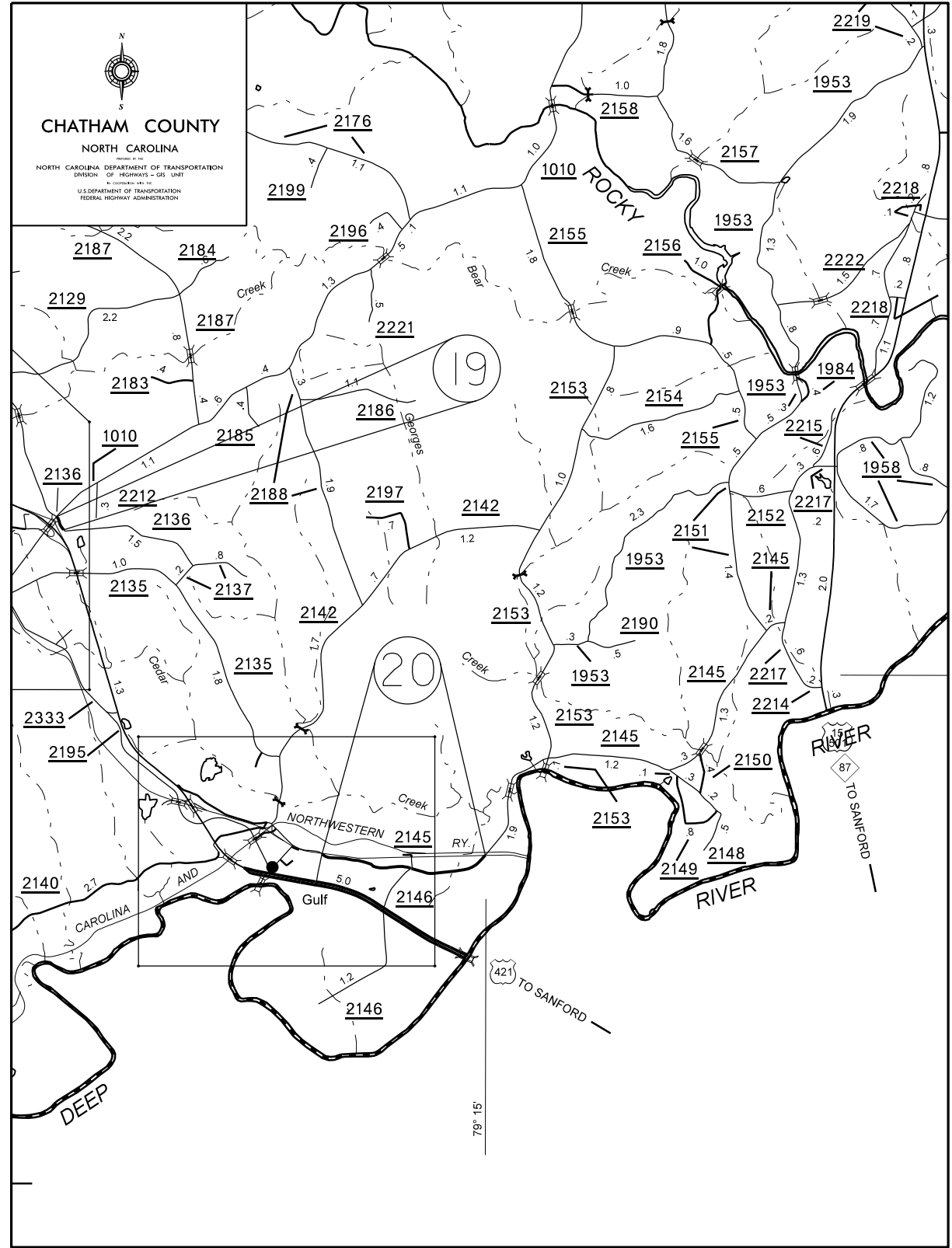

040397  
06-APR-2015 16:40  
g:\proj\2015\chatham\2015 Chatham seal Spring vicinity map.dgn

PROJECT NO.	SHEET NO.	TOTAL NO.
8SP.20195.1	6	

**SUMMARY OF QUANTITIES**

PROJECT NO	COUNTY	MAP NO	ROUTE	DESCRIPTION	LANES	WARM MIX ASPHALT REQUIRED	LENGTH MI	WIDTH FT	ASPHALT SURFACE TREATMENT, DOUBLE SEAL SY	EMULSION FOR ASPHALT SURFACE TREATMENT GAL	BLOTTING SAND TON	4413000000-E	4457000000-N	4810000000-E	4810000000-E	
												WORK ZONE ADVANCE/GENERAL WARNING SIGNING SF	TEMPORARY TRAFFIC CONTROL LS	4" WHITE PAINT LF	4" YELLOW PAINT LF	
8SP.20195.1	Chatham	1	SR 1009 (BONLEE CARBONTON RD)	FROM NC 42 TO NC 902	2	NO	5.64	20	66,176.00	36,397		632		119,120	119,120	
<b>TOTAL FOR MAP NO. 1</b>												632		119,120	119,120	
8SP.20195.1	Chatham	2	SR 1102 (COLERIDGE RD)	FROM SR 1104 (COWARD RD) TO SR 1127 (WRENN SMITH RD)	2	NO	0.534	20	6,266.00	3,447		60		11,280	11,280	
<b>TOTAL FOR MAP NO. 2</b>												60		11,280	11,280	
8SP.20195.1	Chatham	3	SR 1103 (LANE JORDAN RD)	FROM SE 1107 (W 3RD ST) TO SR 1102 (COLERIDGE RD)	2	NO	1.238	20	14,526.00	7,990		139		26,150	26,150	
<b>TOTAL FOR MAP NO. 3</b>												139		26,150	26,150	
8SP.20195.1	Chatham	4	SR 1104 (COWARD RD)	FROM RAND CO LINE TO SR 1102 (COLERIDGE RD)	2	NO	0.141	20	1,655.00	911		16		2,980	2,980	
<b>TOTAL FOR MAP NO. 4</b>												16		2,980	2,980	
8SP.20195.1	Chatham	5	SR 1129 (LAMBERT CHAPEL RD)	FROM PVMT JOINTS S OF SR 1147( B BRAY RD) TO SR 1100 (AIRPORT RD)	2	NO	1	20	11,734.00	6,454		112		21,520	21,520	
<b>TOTAL FOR MAP NO. 5</b>												112		21,520	21,520	
8SP.20195.1	Chatham	6	SR 1143 (MILTON MARSH RD)	FROM SR 1176 (OLD US 421 S) TO DEAD END	2	NO	0.43	20	5,046.00	2,776		49				
<b>TOTAL FOR MAP NO. 6</b>												49				
8SP.20195.1	Chatham	7	SR 1161 (E RALEIGH ST)	FROM NC 22 TO SR 1151 (CHATHAM ST)	2	NO	0.46	20	5,398.00	2,969		52		9,820	9,720	
<b>TOTAL FOR MAP NO. 7</b>												52		9,820	9,720	
8SP.20195.1	Chatham	8	SR 1300 (STALEY SNOW CAMP RD)	FROM ALAMANCE COUNTY TO RANDOLPH COUNTY	2	NO	4.629	20	54,314.00	29,873		519		97,800	97,800	
<b>TOTAL FOR MAP NO. 8</b>												519		97,800	97,800	
8SP.20195.1	Chatham	9	SR 1301 (SILK HOPE LIBERTY RD)	FROM ALAMANCE COUNTY LINE TO SR 1346 (PIIKE RD)	2	NO	2.961	20	34,743.00	19,109		332		63,800	63,800	
<b>TOTAL FOR MAP NO. 9</b>												332		63,800	63,800	
8SP.20195.1	Chatham	10	SR 1502 (DORSETT RD)	FROM SR 1003 (SILK HOPE RD) TO DEAD END	2	NO	1	20	11,734.00	6,454		112				
<b>TOTAL FOR MAP NO. 10</b>												112				
8SP.20195.1	Chatham	11	SR 1531 (BOOTH RD)	FROM ORANGE COUNTY LINE TO END OF MAINT	2	NO	0.364	20	4,271.00	2,350		41		7,690	7,690	
<b>TOTAL FOR MAP NO. 11</b>												41		7,690	7,690	
8SP.20195.1	Chatham	12	SR 1656 (HAROLD HART RD)	FROM DEAD END TO DEAD END	2	NO	0.524	20	6,149.00	3,382		59		11,300	11,300	
<b>TOTAL FOR MAP NO. 12</b>												59		11,300	11,300	
8SP.20195.1	Chatham	13	SR 1681 (OFF OF SR 1531 (BOOTH RD))	FROM BEG MAINT TO SR 1531(BOOTH RD)	2	NO	0.077	20	904.00	498		9		1,630	1,630	
<b>TOTAL FOR MAP NO. 13</b>												9		1,630	1,630	
8SP.20195.1	Chatham	14	SR 1700 (N PEA RIDGE RD)	FROM US 64 TO END OF MAINT	2	NO	2.347	20	27,539.00	15,147		263		49,600	49,600	
<b>TOTAL FOR MAP NO. 14</b>												263		49,600	49,600	
8SP.20195.1	Chatham	15	SR 1710 (WILLIAMS POND RD)	FROM SR 1713 (BYNUM RD) TO DEAD END	2	NO	0.193	20	2,265.00	1,246		22				
<b>TOTAL FOR MAP NO. 15</b>												22				
8SP.20195.1	Chatham	16	SR 1751 (BURGESS RD)	FROM SR 1750 (HOLLANDS CHAPEL RD) TO DEAD END	2	NO	0.403	20	4,729.00	2,601		46				
<b>TOTAL FOR MAP NO. 16</b>												46				
8SP.20195.1	Chatham	17	SR 1983 ( COUNTY LN)	FROM SR 1700 (N PEA RIDGE RD) TO DEAD END	2	NO	0.101	20	1,186.00	653		12				
<b>TOTAL FOR MAP NO. 17</b>												12				
8SP.20195.1	Chatham	18	SR 2120 (IKE BROOKS RD)	FROM US 421 TO SR 2170 (RIVES CHAPEL CHURCH RD)	2	NO	2.402	20	28,184.00	15,502		270		50,735	50,735	
<b>TOTAL FOR MAP NO. 18</b>												270		50,735	50,735	
8SP.20195.1	Chatham	19	SR 2136 (JOHN GOLDSTON RD)	FROM SR 1010 (PITTSBORO GOLDSTON RD) TO END PVMT	2	NO	0.1	20	1,174.00	646		193				
<b>TOTAL FOR MAP NO. 19</b>												193				
8SP.20195.1	Chatham	20	SR 2145 (R JORDAN RD)	FROM SR 2139 (GULF RD) TO RR	2	NO	1.612	20	18,915.00	10,404		181		34,100	34,100	
<b>TOTAL FOR MAP NO. 20</b>												181		34,100	34,100	
8SP.20195.1	Chatham	21	SR 2170 (RIVES CHAPEL CHURCH RD)	FROM 2172 (JIM MOODY RD) TO SR 2175 (MC LAURIN RD)	2	NO	1.315	20	15,430.00	8,487		148		27,800	27,800	
<b>TOTAL FOR MAP NO. 21</b>												148		27,800	27,800	
8SP.20195.1	Chatham	22	SR 2180 (DEAN BEAVERS RD)	FROM SR 2207 (SANDY BRANCH CHURCH RD) TO SE 2175 (MC LAURIN RD)	2	NO	1.58	20	18,539.00	10,197		177		33,400	33,400	
<b>TOTAL FOR MAP NO. 22</b>												177		33,400	33,400	
8SP.20195.1	Chatham	23	SR 1908 (PARTIAN RD)	FROM SR 1910 (NEW ELAM CHURCH RD) TO DEAD END	2	NO	0.359	20	4,213.00	2,318		41				
<b>TOTAL FOR MAP NO. 23</b>												41				
<b>TOTAL FOR PROJ NO. 8SP.20195.1</b>							29.41		345,090	189,811	*	3,485	*	568,725	568,625	
<b>GRAND TOTAL</b>												15	3,485	1	568,725	568,625
															1,137,350	

## SIGNING FOR ASPHALT SURFACE TREATMENT

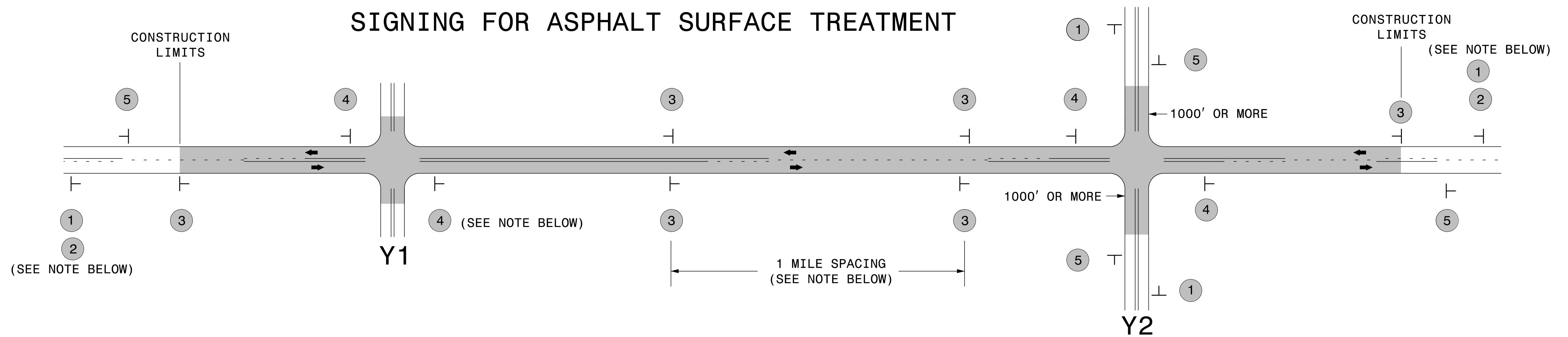

LEGEND	
T	STATIONARY SIGN
←	DIRECTION OF TRAFFIC FLOW

### MAINLINE (-L-) SIGNING

### -Y- LINE SIGNING

SIGNING NOTES AND PLACEMENT PER DIRECTION		
1	 <small>W20-1 48" X 48"</small>	<p>PLACE 1000' PRIOR TO BEGINNING OF CONSTRUCTION LIMITS. ONLY USED ON -Y- LINES IF RESURFACING LIMITS EXTEND 1000' ALONG -Y- LINE.</p> <p>#2 SIGN ONLY USED WHEN RESURFACING LIMITS ARE 2 OR MORE MILES IN LENGTH. ROUND UP TO NEXT WHOLE NUMBER. (NO FRACTIONAL OR DECIMAL NUMBERS)</p>
2	 <small>W7-3aP 24" X 18"</small>	
3	 <small>W8-7 48" X 48"</small>   <small>SP 48" X 48"</small>	<p>ALTERNATE THE FOLLOWING TWO SIGNS:</p> <p>STARTING WITH "LOOSE GRAVEL" (W8-7) FOLLOWED BY "UNMARKED PAVEMENT".</p> <p>PLACE INITIALLY AT THE CONSTRUCTION LIMITS AND SPACED 1 MILE APART THEREAFTER. IF NO -Y- LINES EXIST, PLACE 2ND SET 1/2 MILE FROM THE CONSTRUCTION LIMITS AND THEN SPACE 1 MILE THEREAFTER.</p>
4	 <small>SP 13106 48" X 48"</small>	<p>THESE ARE FOR -Y- LINES THAT ARE "THROUGH" ROADWAYS. DEAD END AND SUBDIVISION ROADS ARE NOT "THROUGH" ROADWAYS. INSTALL 500' +/- FROM EACH -Y- LINE APPROACH AS SHOWN ABOVE. FOR MULTIPLE -Y- LINES THAT ARE SEPARATED BY 0.25 MILES OR LESS, TREAT AS A SINGLE UNIT AND INSTALL WITHIN 500' OF EACH APPROACH. A MAXIMUM OF 2 SIGN SETS PER MILE. DO NOT INSTALL WHEN -Y- LINES ARE WITHIN 0.5 MILES FROM "END ROAD WORK" SIGN.</p>
5	 <small>G20-2 A 48" X 24"</small>	<p>PLACE 500' FOLLOWING THE END OF CONSTRUCTION LIMITS.</p>

NO REQUIRED STATIONARY SIGNING FOR THE FOLLOWING -Y- LINE CONDITIONS:

- 1) LESS THAN 1000' OF RESURFACING ALONG -Y- LINE
- 2) SUBDIVISION ROADS
- 3) DEAD END ROADS

WHEN PAVING/CONSTRUCTION ACTIVITIES PROCEED ACROSS AN UNSIGNED -Y- LINE, ADVANCE WARNING PORTABLE SIGNS SHALL BE USED ALONG THE -Y- LINE AS SHOWN BELOW. REMOVE UPON COMPLETION OF WORK.

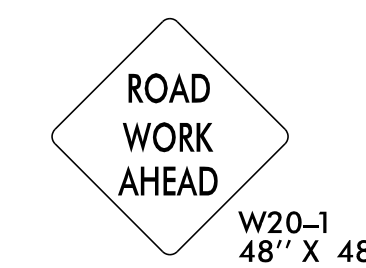

PLACED 500' IN ADVANCE OF FLAGGER. PLACED 250' IN ADVANCE OF FLAGGER.

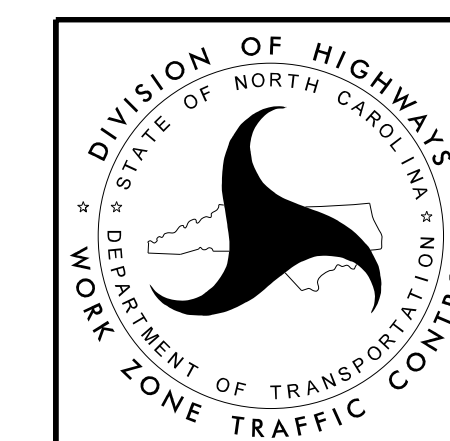

**ADVANCE WARNING SIGNS  
FOR  
ASPHALT SURFACE TREATMENTS  
2 LANE ROADWAYS**